

INSTRUKCJA MONTAŻU

FURTKA OGRODZENIOWA
SZAFIR

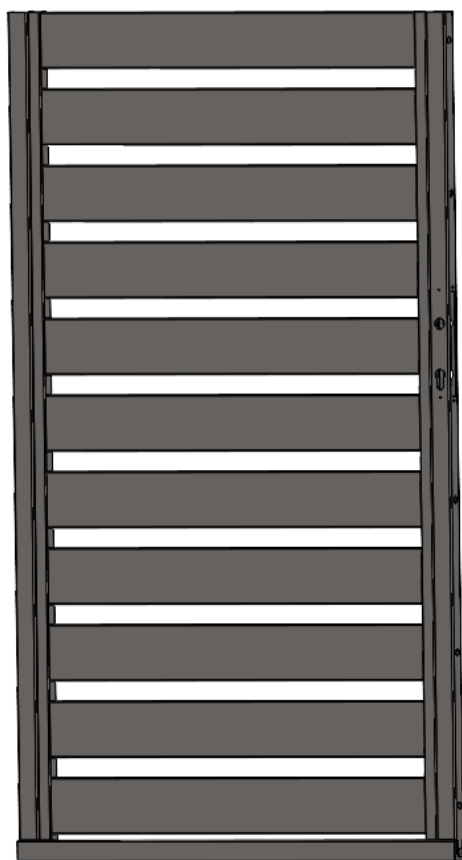

ZAWARTOŚĆ OPAKOWAŃ

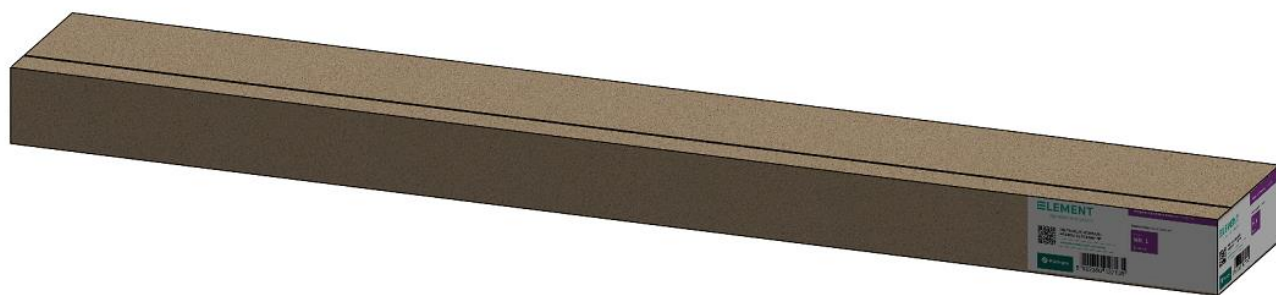

6x



5x



2x



1x



1x



1x



2x (M8x70) [A]



12x (M6x25) [B]

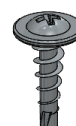

10x [C]

2x [D]



2x [E]



10x [F]



10x [G]



1x [H]



POTRZEBNE NARZĘDZIA

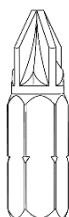
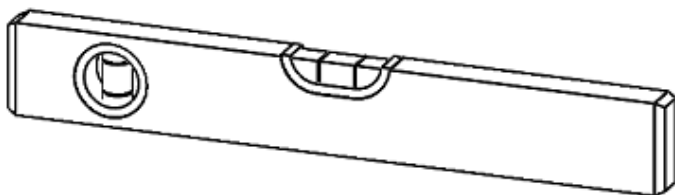
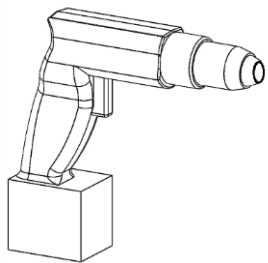
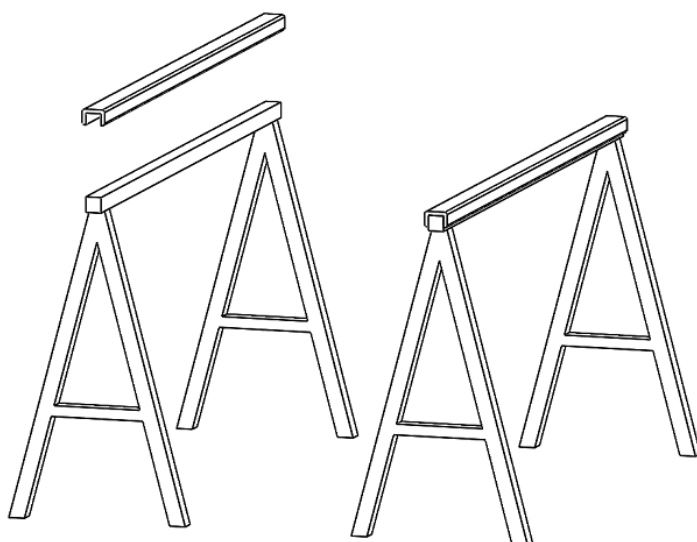

BIT PH 2

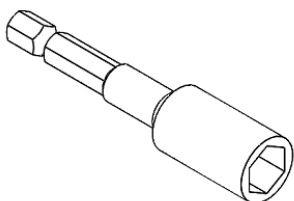

HEX M8

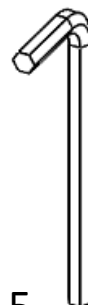

HEX 5

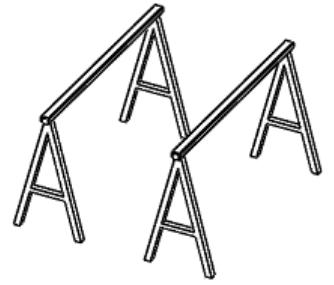
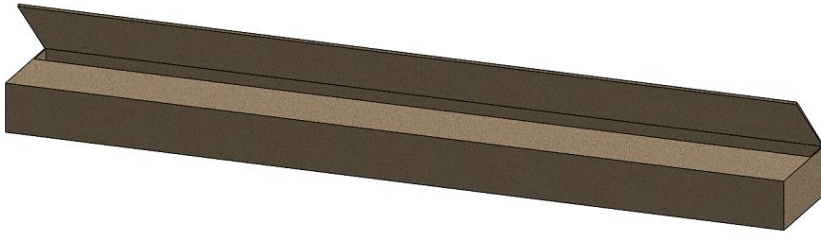

[1]

[G]



[C]

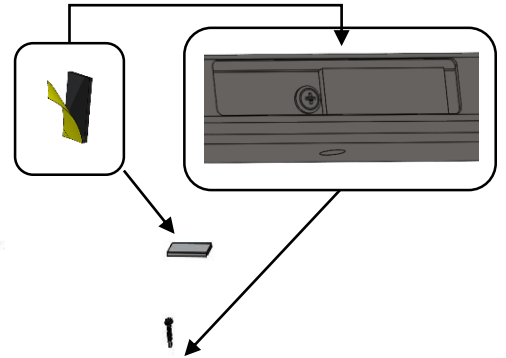

[2]

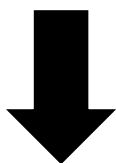
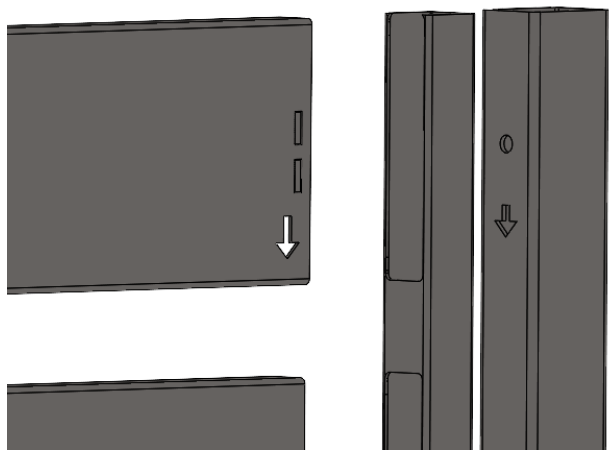

[B]

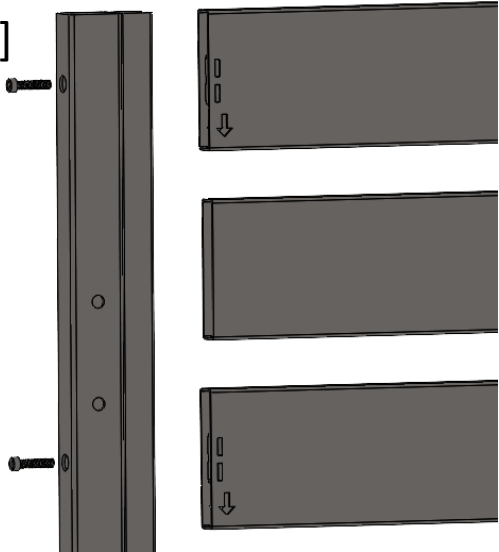

[3]

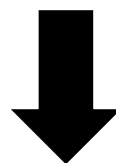
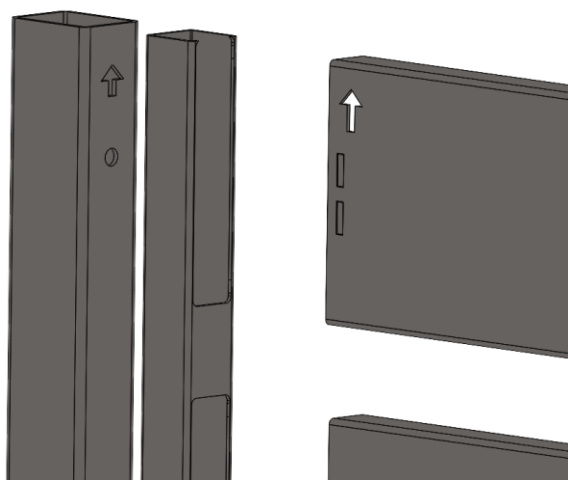

[B]

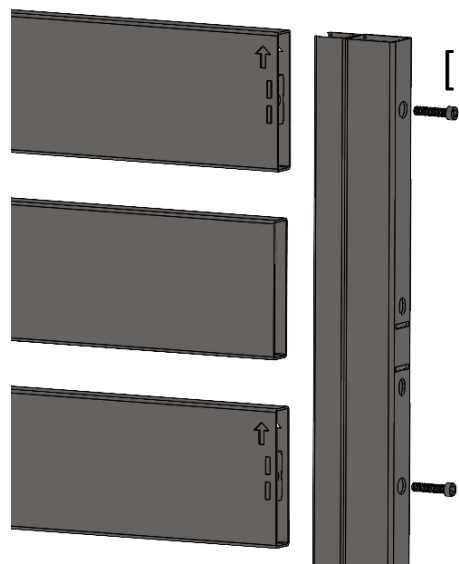

[4]

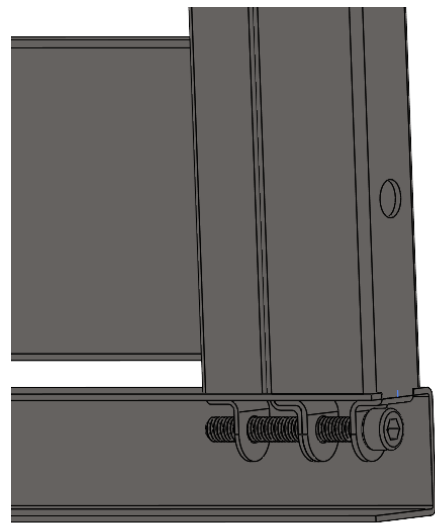
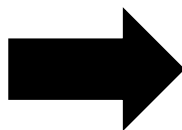
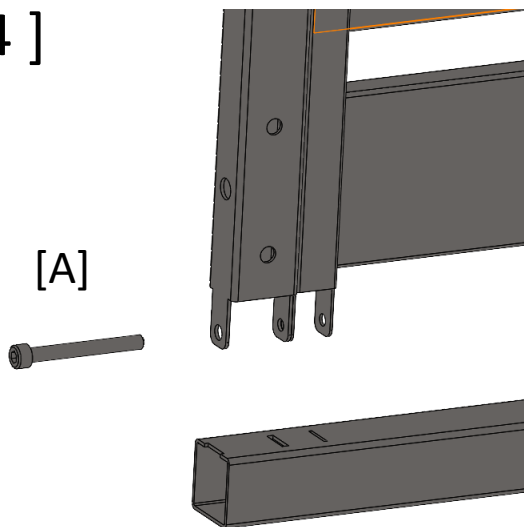

[5]

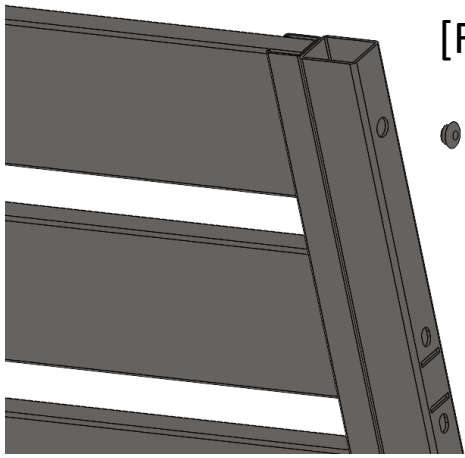

[6]

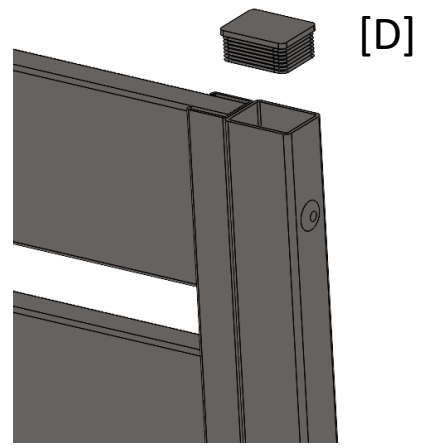

[7]

